

**ACCLAIM**  
TRAVEL TRAILERS

# ACCLAIM

TRAVEL TRAILERS



**FOREST  
RIVER**

[EASTTOWESTRV.COM/ACCLAIM](http://EASTTOWESTRV.COM/ACCLAIM)  
A DIVISION OF FOREST RIVER, INC.



**EAST WEST**

### 1600RBX-LE



HEIGHT: 10' 3" LENGTH: 21' WIDTH: 96" UVW (lbs): 3518 HITCH: 340  
CCC: 1222 GVWR: 4740 TANKS (F/B/G): 40/30/30 TIRE SIZE: 15"

### 1610BHX-LE

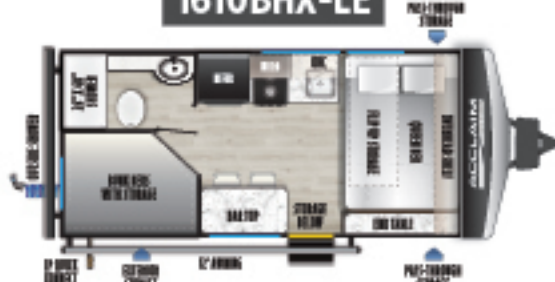

HEIGHT: 10' 3" LENGTH: 21' WIDTH: 96" UVW (lbs): 3513 HITCH: 385  
CCC: 1272 GVWR: 4785 TANKS (F/B/G): 40/30/30 TIRE SIZE: 15"

### 2300RD



HEIGHT: 10' 9" LENGTH: 27' 10" WIDTH: 96" UVW (lbs): 4953 HITCH: 565  
CCC: 2612 GVWR: 7565 TANKS (F/B/G): 40/30/30 TIRE SIZE: 15"

### 2350BH



HEIGHT: 10' 10" LENGTH: 28' 8" WIDTH: 96" UVW (lbs): 6153 HITCH: 700  
CCC: 1447 GVWR: 7600 TANKS (F/B/G): 40/30/60 TIRE SIZE: 15"

### 2400BH



HEIGHT: 10' 5" LENGTH: 28' 7" WIDTH: 96" UVW (lbs): 4908 HITCH: 620  
CCC: 2712 GVWR: 7620 TANKS (F/B/G): 40/30/30 TIRE SIZE: 15"

### 2450ML



HEIGHT: TBD LENGTH: TBD WIDTH: 96" UVW (lbs): TBD HITCH: TBD  
CCC: TBD GVWR: TBD TANKS (F/B/G): TBD TIRE SIZE: 15"

### 2500RD

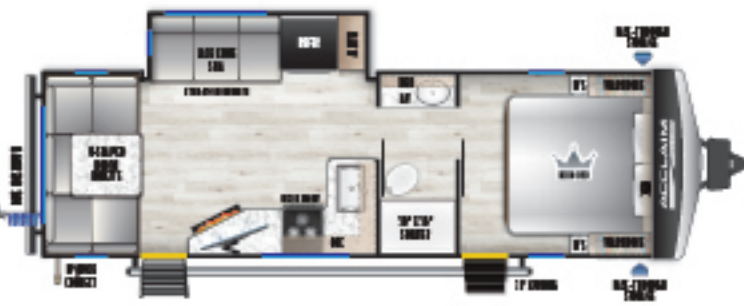

HEIGHT: 10' 7" LENGTH: 29' 10" WIDTH: 96" UVW (lbs): 5913 HITCH: 635  
CCC: 1722 GVWR: 7635 TANKS (F/B/G): 40/30/60 TIRE SIZE: 15"

### 2550DS



HEIGHT: 10' 10" LENGTH: 30' 8" WIDTH: 96" UVW (lbs): 6518 HITCH: 725  
CCC: 1800 GVWR: 8318 TANKS (F/B/G): 40/30/90 TIRE SIZE: 15"

### 2600RB



HEIGHT: 10' 9" LENGTH: 30' 6" WIDTH: 96" UVW (lbs): 6158 HITCH: 720  
CCC: 1562 GVWR: 7720 TANKS (F/B/G): 40/30/60 TIRE SIZE: 15"

### 2650FL



HEIGHT: TBD LENGTH: TBD WIDTH: 96" UVW (lbs): TBD HITCH: TBD  
CCC: TBD GVWR: TBD TANKS (F/B/G): TBD TIRE SIZE: 15"

### 2700BH



HEIGHT: 10' 9" LENGTH: 31' 8" WIDTH: 96" UVW (lbs): 6403 HITCH: 670  
CCC: 1267 GVWR: 7670 TANKS (F/B/G): 40/30/60 TIRE SIZE: 15"

### 3250QB



HEIGHT: 10' 11" LENGTH: 37' 8" WIDTH: 96" UVW (lbs): 7518 HITCH: 780  
CCC: 3462 GVWR: 10980 TANKS (F/B/G): 40/30/60 TIRE SIZE: 15"

## EAST TO WEST ENDURE PACKAGE (STANDARD)

- Enclosed & Heated Underbelly
- Enclosed Tanks
- RV Carbon Monoxide and Propane Gas Alarm
- In-Cabinet Heat
- 81" Interior Ceiling Height Throughout
- Solid Privacy Bedroom Door (where applicable)
- King Size Bed (where applicable)
- C-Pap Storage (Bedside) (where applicable)
- Mirrored Wardrobes
- Fitted Bed sheet
- Under-Bed Struts (Main Bed - where applicable)
- Residential Inspired Kitchen & Living Spaces
- Seamless Countertops (No T-Mold)
- LED Lighting w/ Motion Sensor
- Designer Pull-Out Waterfall Kitchen Faucet
- Stainless Steel Kitchen Sink
- Integrated Soap Dispenser
- 2-Burner Range w/ Microwave
- 10.7 Cubic Foot Electric 12V Refrigerator

- Sliding Kitchen Picture Window (where applicable)
- Pull Out Dinette Storage Drawers on Roller Guides (where applicable)
- USB & C-Port Charging Stations (Beds, Bunks, & Tables) (where applicable)
- 5K BTU Electric Fireplace (where applicable)
- Mounted 12V Bluetooth Speaker w/ Color-Change LED
- Shower Surround w/ Skylight (where applicable)
- Foot Flush Toilet
- Black Tank Flush
- Fully Finished Pass-Through Storage w/ Magnetic Latch Door
- Solid Entrance Step Main Door (N/A on LEs)
- Outside Shower w/ Hot & Cold Water
- Exterior LED Light Strip Under Awning & Front Cap
- Power Awning w/ Adjustable Legs
- Battery Disconnect
- Friction-Hinge Doors
- Cable/Satellite Ready
- 7- Way Plug and Chain Holder
- Tankless On-Demand Water Heater

- Ducted A/C w/ Quick Cool
- 35K BTU Furnace (19K BTU In LEs)
- Detachable Power Cord
- Power Tongue Jack (N/A on LEs)
- Roof Mounted Solar Prep
- Backup Camera Prep
- Exterior Ladder Prep
- Slide Out Awning Prep
- Magnadyne RV-Link w/ LTE & WI-FI Prep
- Pet Friendly D-Ring
- LP Quick Connect for Outdoor Grill

## OPTIONS

- Spare Tire & Carrier (Standard All Models)
- 2nd A/C Prep (Standard on 2500RD & Up) (N/A on LEs)
- LED Smart TV w/ Swing Out TV Bracket (N/A on LEs)
- Aluminum Wheels (N/A on LEs)
- 2nd A/C Installed (2500RD & Up)
- Solar Package w/ 200-Watt Panel & 30 Amp Controller





**TRAVEL TRAILERS**



**TOY HAULERS**



**FIFTH WHEELS**



**MOTORHOMES**

**EAST TO WEST TAKES PRIDE IN OUR FIVE GUIDING PRINCIPLES AND OUR CORPORATE PHILOSOPHY** which focuses on people working together to create high quality, value-added products that deliver the ultimate RV experience.

**Sustainable Manufacturing**

An important objective to our strategy and operations is to implement economically sound manufacturing processes to reduce/recycle waste & conserve energy and natural resources.

**Corporate & Social Responsibility**

We foster a business environment in which we focus on and practice:

- Ethical Labor Practices
- Teamwork
- Philanthropy
- Volunteering

**Culture & Values**

We are a forward thinking company committed to fostering a culture of teamwork. By being transparent, we encourage our employees to think outside the box and make a difference!

**Quality & Construction**

Our team takes pride in each unit we build. Our manufacturing standards and point to point inspections ensure each EAST TO WEST brand is built to the same quality specifications every time.

**Our Commitment**

We strive to provide the highest quality products at the best possible price to our customers. We invite you to be a part of the EAST TO WEST family and we look forward to exceeding your expectations!

**EACH NEW FOREST RIVER PURCHASE PROVIDES:**

- ✔ Pre-delivery Inspection.
- ✔ Digital Owner's Manual.
- ✔ Free Membership to Forest River Owners Group (FROG). Learn more at [www.forestriverfrog.com](http://www.forestriverfrog.com).
- ✔ A Contribution to Care Camps Foundation [www.carecamps.org](http://www.carecamps.org).
- ✔ 1 Year Free Roadside Assistance from Date of Purchase.



**SPEC DEFINITIONS:**

Scan on your smartphone to learn RV terminology and more!



**LEARN MORE:**

Scan this QR code with your mobile device to learn more about Forest River.



All information contained in this brochure is believed to be accurate at the time of publication. Depictions of models contained in this brochure are for illustrative purposes only. Actual product may vary from the information in this brochure due to changes in the manufacturing process and equipment. Forest River, Inc., reserves the right to make any changes without notice, including prices, colors, combinations, materials, equipment, and specifications of any model as well as the addition of new models and the discontinuance of models shown in this brochure. Therefore, please consult with your Forest River dealer and confirm the availability of any materials, combinations, designs, or specifications that are meaningful to your purchase decision. © 2026 East To West, a Division of Forest River, Inc., a Berkshire Hathaway Company. All Rights Reserved. Forest River, Inc. 01/26